



# ***SPORT-FI***

**S6 IN-EAR SPORTS HEADPHONE  
WITH MEMORY WIRE**

user manual

[www.meelec.com](http://www.meelec.com)

Thank you for your purchase of the

## ***SPORT-FI***

**S6 In-Ear Sports Headphone with Memory Wire**

**Please read this manual in its entirety.**

If you have any issues after reading the manual

please contact

**MEElectronics customer service at**

customerservice@meelec.com

or (626) 965-1008 x31

 brings musical enjoyment to everyone

# TABLE OF CONTENTS

Package Contents	1
Warning	2
Safety Tips	
First Use: Selecting Tips	3
How to Wear: Installing Tips	4
How to Wear: Inserting Earpiece	5
How to Wear: Securing Memory Wire	6
How to Wear: Optional	7
Short Cable and Extension Cable	8
Earphone Removal	9
Use While Exercise	
Use While Traveling	
Care and Storage	10
Cleaning	11
Burn In	12
Warranty	
Troubleshooting	13

# Package Contents



Sports  
Headphones  
with Memory  
Wire



6 Pairs of  
Eartips



3.5 mm  
Extension  
Cable



Zipper  
Carrying  
Case



Universal  
Sports  
Armband



User  
Manual



Shirt  
Clips  
x2

# Warning



## **Please Read: Important Safety Information to Avoid Personal Injury!**

Statistics show that using noise isolating earphones while walking, jogging, or running in areas with moving vehicles or trains significantly increases the potential of accident which leads to personal injury or death.

We strongly discourage using noise isolating earphones while walking, jogging, running, cycling, driving, operating machinery, or performing other activities that require hearing surrounding sounds.

Do not use headphones at high volumes for extended periods of time as doing so will result in permanent hearing damage. It is advised that you keep volume levels moderate to low at all times for your safety.

Please visit [www.osha.gov](http://www.osha.gov) for more info.

## **Safety Tips**

It is advised to turn the volume on your music player all the way down before connecting your MEElectronics earphones. After the earphones are connected and sealed in your ears, gradually increase the volume until you reach a comfortable listening level.

Achieving a good seal will isolate you from outside noises allowing you to play your music at lower volume levels.

# First Use: Selecting Tips

The MEElectronics S6 earphone uses an over-the-ear design with memory wire, please follow the instructions in the manual to make sure you get a proper, locked-in fit. Prior to the first use, it may take several minutes to get the correct fit which will result in better sound and a more secure fit. Subsequent use should not require adjustments.

## Select and install the correct ear tips for your ears

This may require trying multiple sizes/types of ear tips. If you have larger ears, try the larger tips first, if you have smaller ears, try the smaller tips first. Because ear canals may not be symmetric, you may need to use different-size ear tips in each ear. When changing ear tips, make sure they are installed securely before putting the earpiece in your ear.

**Bi-flange Tips (installed):** The bi-flange tips utilize two soft silicone flanges and will fit most ear sizes. This is a good ear tip to start with, and if it is too big, you can go to a small triple flange or small single flange tip. If it is too small, please try the triple flange tips or large single flange ear tips.



**Large Triple-Flange Tips:** Providing a deep insertion, the large triple flange ear tips fit many large ears and offer the best seal. They are designed to be pushed all the way into the ear; however, if you experience discomfort at any time you should not push the tip in any further.



**Small Triple-Flange Tips:** These tips are included if the large triple flange tips are too big for you but you need a longer ear tip due to the shape of your ears.



**Small, Medium, Large Standard Silicone Tips:** These tips are included to help ensure you will get a comfortable fit with a good seal. Many people report these tips work well for their ears.



## How to Wear: Installing Tips



**Hold the ear tip firmly in one hand and the earpiece in the other**



**Put the tube of the ear tip on the nozzle of the ear piece as shown. Holding the ear tip at a slight angle will help with insertion.**



**Push the ear tip all the way on the nozzle. Test to make sure the fit is secure by gently pulling on the tip; it should not come loose.**

**Caution:** Always make sure ear tips are installed completely on the earphone nozzle to avoid an ear tip coming off in your ear. Frequent cleaning of the outer portion of the nozzle and the ear tips, including inside the stalk, will help keep them in place. Please see the 'Care and Storage' section for tips on cleaning your earphones and ear tips.

# How to Wear: Inserting Earpiece

## **Straighten the memory wire and insert the earpiece into your ear**

Each earphone is marked with a R for right and L for left channels and are not swappable.

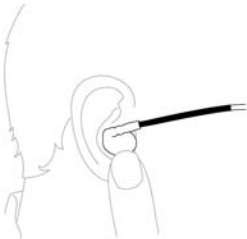

**Move the earpiece around until the ear tip seats in your ear canal and the housing fits within your ear**



**The earpiece should be flush in your ear and you should not be able to see the ear tip**

Pulling your upper part of your ear upwards and back while inserting your earphone may improve your ability to get a deep insertion at the proper angle. Moistening the ear tips prior to insertion may make insertion easier.



# How to Wear: Securing Memory Wire

Make sure your earphone is seated correctly in your ear before adjusting the memory wire.



**Bend the memory wire around your ear**



**The cable should hang down and you should have a secure fit**

# How to Wear: Optional

Tighten the cable cinch and use the shirt clips to control cable movement during activities.



**Slide the cable cinch up or down**



**Move the cable cinch to shorten cable after the Y split**

The slider can effectively shorten the length of the cable after the Y split for use behind the back or to keep them in place more securely. The cable slider can also be slid toward the earphones to reduce tangling during storage.



**Shirt clip holds cable in place**



**Over-the-ear with cable in front**



**Over-the-ear with cable in back**

The cable and extension cable both come with attached shirt clips that can hold the cable where you want it and keep it from getting in the way during activities.

# Short Cable and Extension Cable

The MEElectronics S6 earphone can be used with the provided extension cable or without, as a short cable.



**Use without the extension cable**



**Use with the extension cable**

# Earphone Removal

**DO NOT REMOVE FROM YOUR EAR BY PULLING ON THE CABLE!**

Gently wiggle the earphone before removal to break the seal. Pull the earpiece straight out of your ear and then unwrap the cable from over your ears. Try not to bend the memory wire too much (some will be necessary) to reduce the time it takes to put the earphone on during subsequent uses.

# Use While Exercise

The MEElectronics S6 is ideal for exercise as the over-the-ear fit will keep them in place during just about any activity. If you must remove and reinsert the earpieces, try to avoid getting sweat in the nozzle as this will cause a temporary reduction/loss of sound. Please do not use earphones when performing exercise that requires you to hear your surroundings, such as cycling or running outdoors.

# Use While Traveling with Altitude Changes (Airplane/Car/Train/etc.)

During large, rapid changes in altitude you will experience pressure changes which will affect the way you hear your earphones. It is recommended that you break the seal when you feel increased pressure due to altitude changes to maintain the best sound quality.

# Care and Storage

Removing the cable from your device:

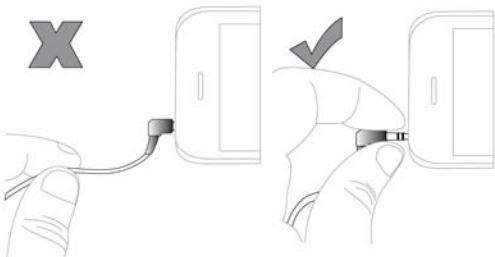

**Do not pull on the cable, remove from the hard plastic of the 3.5mm plug**

Use the included carrying case to protect the S6 while not in use.

For best results, either wrap the cable around 3 fingers before placing in the carrying case, or just bunch the earphone cable up and put in the carrying case. The bunching method will result in less tangling after removing your earphone from the case.

# Cleaning

Cleaning your MEElectronics products regularly is hygienic and will help keep the earphones looking their best. Please follow these steps when cleaning your MEElectronics earphones:

- Gently remove the ear tips from your earphone
- Take a cotton swab that is either dry or has a small amount of rubbing alcohol or 3% hydrogen peroxide solution on it
- Swab around the nozzle of the earphone, but not the inside of the nozzle
- Swab the ear tip including the inside of the stalk
- Ear tips can also be submerged fully in rubbing alcohol or hydrogen peroxide
- Wait for the earphones and ear tips to dry completely
- Put the tips back on the earphone, making sure they are fitted securely

## Burn In

Burn in is the phenomenon of dynamic driver headphones improving their sound over the first several hours of use. Burn in is not necessary to enjoy your MEElectronics headphones. However, many people report improvement in sound quality with burn in. Burn in will occur naturally while listening to your headphones, but if you are a critical listener, you may want to accelerate this process by letting music play at a moderate level continuously for anywhere from a day to a week. 50 hours is a good number to aim for. If you do not notice a difference after your headphone has burned in, that is OK as the changes can be subtle and everyone's auditory memory is different.

## Warranty

The S6 is covered by a 1 year manufacturer warranty.

For issues with your product, contact [customerservice@meelec.com](mailto:customerservice@meelec.com).

For US warranty claims, contact [support@meelec.com](mailto:support@meelec.com).

For international warranty claims contact your retailer.

# Troubleshooting

**Issue: Lack of Bass, the Sound is Quiet, Thin, and/or Tinny**

**Resolution:** Fit and ear tips play a major role in how you hear your earphones. If the bass on your MEElectronics earphones is missing or seems weak, you have not achieved a good seal with your earphone. If the earphones sound quiet, you are more than likely not inserting them deep enough in your ears. Also, the large triple flange tips can bend in your ear canal, muffling the sound.

Please check the 'First Use' section for instructions on achieving the best fit for you. If the user manual does not resolve your issues, please contact customer service at [customerservice@meelec.com](mailto:customerservice@meelec.com) for further assistance. Our earphones have received acclaim from reviewers, enthusiasts, and customers so please let us help you enjoy your MEE products!

**Issue: Earpieces Won't Stay in Your Ears:**

**Resolution:** Several things can cause the earpiece to come out of your ears including:

- The ear tips are the incorrect size for your ear canal. Try other sizes of ear tips.
- The M6 is not inserted at the best angle for your ears. Straighten the memory wire and adjust the earpiece until seated properly. The ear tip should hold the earpiece in your ear without the memory wire.
- The ear tips have a buildup of bodily fluids. Clean the ear tips as described in this manual.



# Troubleshooting Continued

## **Issue: Crinkling Sound**

**Resolution:** A crinkling sound experienced when inserting one or both of the earpieces is not unusual and is caused by air pressure in your ear compressing the very thin driver diaphragm. It can even lead to a temporary reduction or loss of sound after insertion. If you experience a reduction or loss of sound in one or both ears, you can pull on your upper ear or pull the earphone out slightly to relieve the pressure, which should restore the sound. The crinkling while inserting will go away over time and use (typically 1-4 weeks with regular use). Using different ear tips may also reduce/eliminate the crinkling.

## **Issue: Static**

**Resolution:** Static crackling sounds can be caused by static electricity due to electrical charge. This usually occurs during dry weather and with the use of heating or some air conditioning. If you are experiencing static crackling sounds, it is recommended that you relieve the static buildup or cease use of electronic devices. While damage from static electricity is not likely, it is possible with high amounts of static charge and older or improperly grounded electronics.

## **Issue: Sound Imbalance**

**Resolution:** If one ear is louder than the other, the easiest way to check if it is the earphone is to switch the earphones around (i.e. put the left channel in your right ear and the right channel in your left ear). If you still hear a lower volume with the same channel, but now in your other ear, try a different source (MP3 player, computer headphone jack, etc) and see if the problem persists. If the problem goes away or there is a problem with the same ear, this is caused by a fit issue and/or air pressure build-up in your ear (see 'Crinkling Sound' above for possible solutions). If the problem persists, contact customer service at [customerservice@meelec.com](mailto:customerservice@meelec.com) for further assistance.

## **Issue: Static or Other Noise When Plug is Moved**

**Resolution:** If the plug or inside of the jack is not clean you may hear static, clicking, or other noise when the plug is moved, or rarely even without any movement. Please clean the plug with a soft cloth or isopropyl alcohol. For information on cleaning the inside of the headphone jack, please consult your phone/media player manufacturer.

# ***SPORT-FI***

## **S6 IN-EAR SPORTS HEADPHONE WITH MEMORY WIRE**

**Please read this manual in its entirety.**  
If you have any issues after reading the manual

please contact  
**MEElectronics customer service at**

customerservice@meelec.com  
or (626) 965-1008 x31



817 Lawson St.  
City of Industry, CA 91748

MEElectronics and its logo are  
registered trademarks of S2E, Inc.  
All rights reserved.